

## Wire Hanger



### Ideal for fixing suspended ceilings

A one piece all metal load assisted suspension anchor.

### Specification

After inserting into the hole, a swift tug sets the anchor. Under loading, the expansion cone draws into the expansion sleeve ensuring an even, more secure fix.

### Substrates

- Concrete

#### Material

Forged and pierced metal body - Zinc plated 5µm.

Pressed steel expansion segment - Zinc plated 5µm.

### Applications

- Fixing cables for suspended ceiling applications

### Installation Equipment

- Rotary Hammer (SP21, 322, 327, HDI 244)
- Correct size drill bit
- Blow Out Pump
- Hammer

### Installation

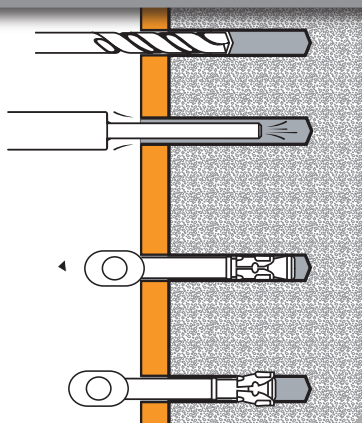

1. Drill hole with correct size drill bit to recommended depth and diameter (see table attached).
2. Remove debris from hole by blowing out with compressed air or hand held blow out pump.
3. Insert anchor into hole using light hammer blows.
4. Set anchor using claw hammer.

## Product Range - Wire Hanger

<b>Eurocode</b>	<b>Anchor Diameter</b>	<b>Drill Diameter</b>	<b>Drill Depth</b>	<b>Eye Diameter</b>	<b>Anchor Length</b>	<b>Max Fixture Thickness</b>	<b>Concrete Tensile Loads</b>
920837	6mm	6mm	43mm	6.2mm	64mm	50mm	1.5kN