

Satelis Hollow Material Fixing System



Gives high loads in hollow base materials

Use with Epcon and Epomix anchoring systems for all your hollow base material applications.

Specification

Satelis spring loaded action of the assembly ensures contact with the substrate. Insert the resin and install the socket or stud assembly.

Polypropylene body, polyacetal spring and high density polyethylene flange assembly, resin retainer, zinc plated metal studs (steel S300Pb, zinc coating NFA35561), Zinc plated metal sockets (steel S300Pb, zinc coating NFA35561), nut grade 6 (NFE 25400-0, zinc coated), washer E24 zinc coated NFE 25513111.

Substrates

- Hollow block
- Hollow floor slab
- Hollow brick
- Plasterboard

Applications

- Signs
- Electrical switchboards
- Radiators
- Hand rails

Installation Equipment

- Rotary Hammer (SP21, 322, 327, 331, 335, HDI 244, HDI 220)
- Correct size drill bit (20mm)
- Torque wrench
- Appropriate size hexagon drive socket

Installation

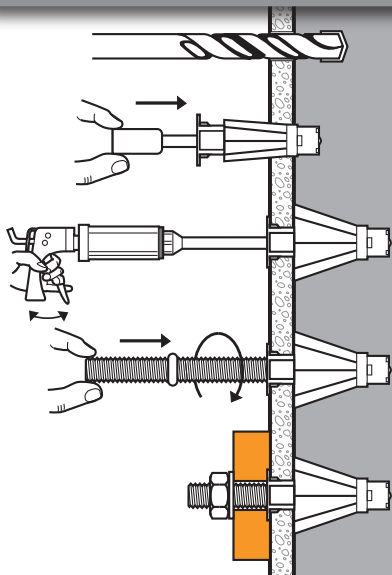

1. Drill hole with correct size drill bit through substrate into cavity (see table attached).
2. Insert Satelis and ensure fixing has expanded and is stable.
3. Assemble nozzle onto cartridge. Extrude resin until an even mix is achieved then inject into Satelis until completely full. Slowly extract nozzle whilst injecting.
4. Insert stud by hand to full depth, using a slow rotating method. This will ensure that any air pockets escape ensuring a correct setting.
5. Allow resin to cure for specified period, details found on tube and vary according to air temperature, prior to applying recommended torque.

Product Range - Satelis Hollow Material Fixing System

Eurocode	Description	Thread Diameter	Hole Diameter	Stud Type	Stud Length	Internal Thread Length	Fixture Thickness
062340	M6 x 58	6mm	20mm	Socket	N / A	15mm	N / A
062300	M8 x 80	8mm	20mm	Stud	80mm	N / A	10mm
062350	M8 x 58	8mm	20mm	Socket	N / A	20mm	N / A
062310	M10 x 90	10mm	20mm	Stud	90mm	N / A	18mm
062360	M10 x 58	10mm	20mm	Socket	N / A	23mm	N / A
062320	M12 x 90	12mm	20mm	Stud	100m	N / A	25mm

Satelis Hollow Material Fixing System Indicative Tensile Loads in Concrete

Thread Diameter	Hole Diameter	Stud Type	Torque	Hollow Block Tensile Load	Hollow Beam Tensile Load	Hollow Block Shear Loads	Hollow Beam Shear Loads
M8	20mm	Female	8Nm	1.1Nm	0.4kN	1.55kN	0.45kN
M10	20mm	Both	10Nm	1.1Nm	0.4kN	2.40kN	0.45kN
M12	20mm	Both	20Nm	1.1Nm	0.4kN	2.40kN	0.45kN